

Local Information

Venue

SICE 2023 is held at Mie University, the only national university in Mie Prefecture. Mie University is located at center of Tsu city. It is easy to access from Nagoya Station by train and from Central Japan International Airport by fast ship (<https://www.mie-u.ac.jp/en/about/map/>).

Tsu city has easy access to Ise Jingu, Shima Kanko Hotel, Toba Aquarium, Suzuka Circuit, Iga-ryu Ninja Museum, Nagashima Spa Land etc. (<http://www.travel.pref.mie.lg.jp/>). Please enjoy the conference and sightseeing.

The convention venue is divided into two areas. One is Sansui Hall for registration, technical exhibitions, poster sessions, etc. The other is the presentation rooms.

Venue overview

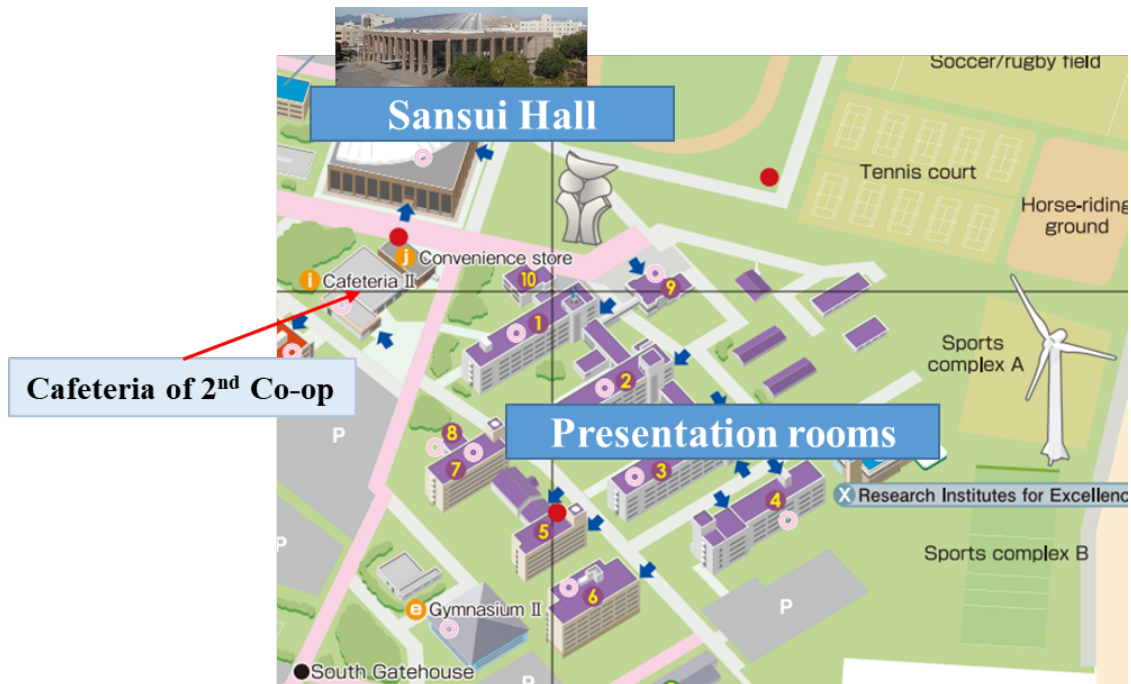

Floor map of Sansui Hall

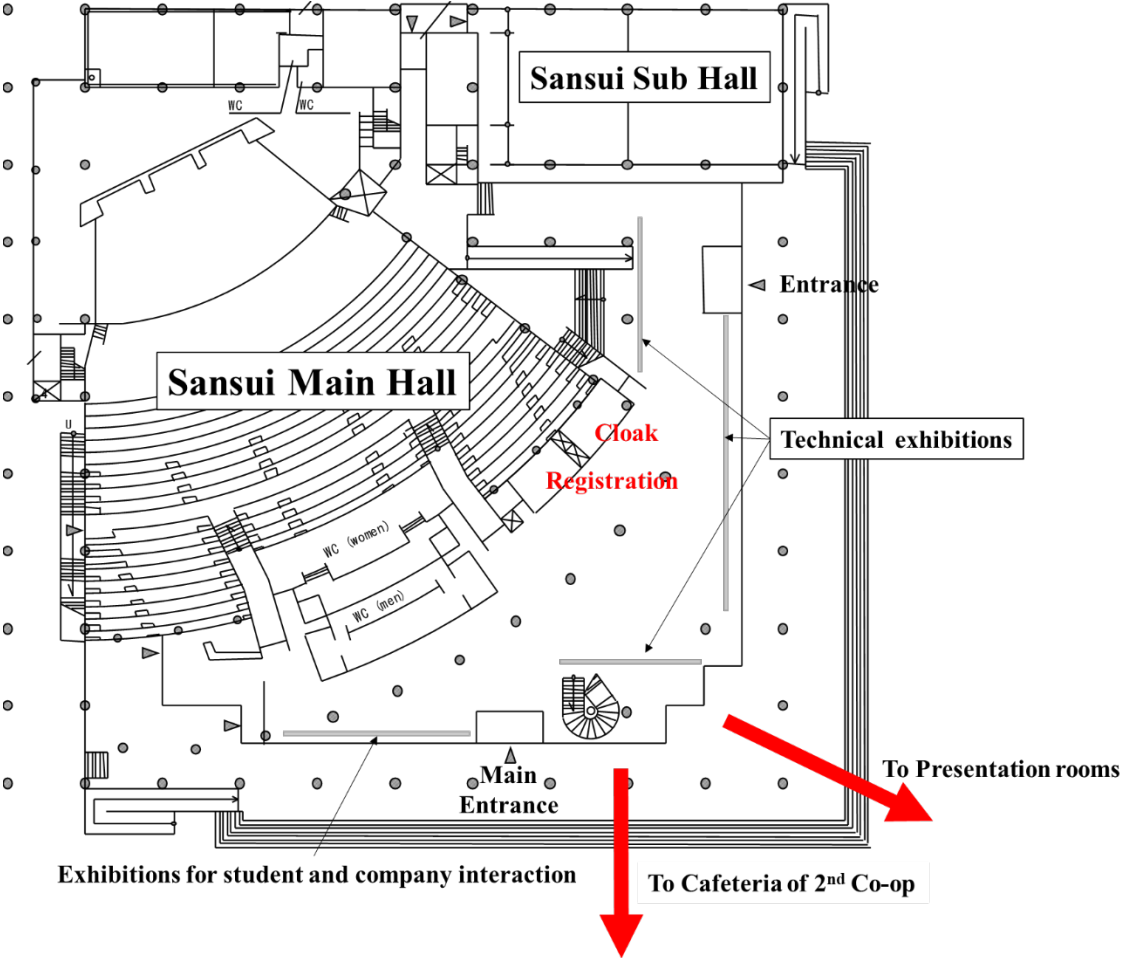

Floor map of presentation rooms (Faculty of Engineering)

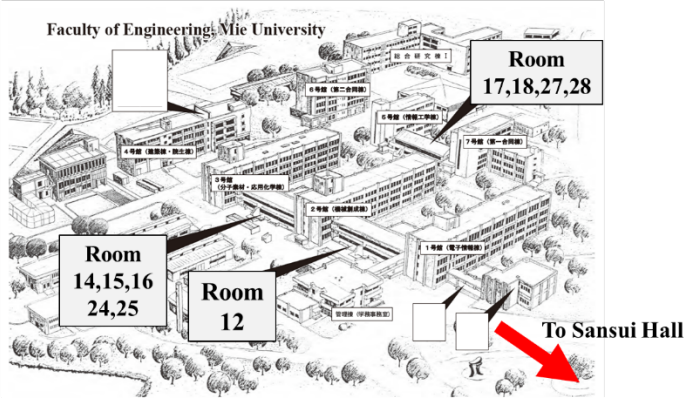

Floor map
Room 12(1st floor)

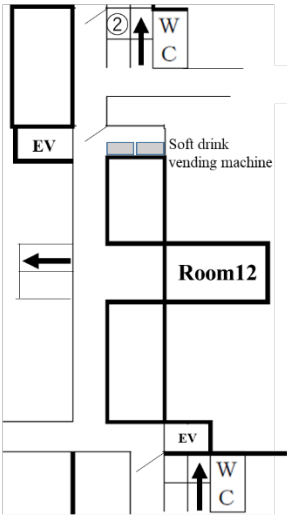

Room 14,15 and 16(1st floor)

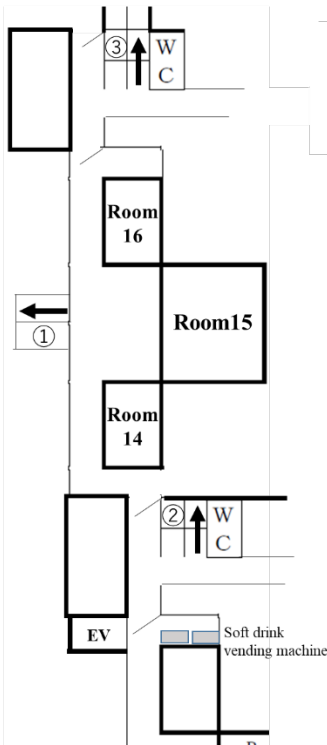

Room24 and 25(2nd floor)

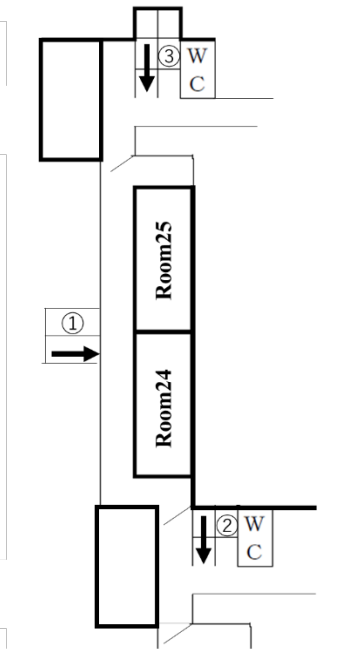

Room17 and 18 (1st floor)

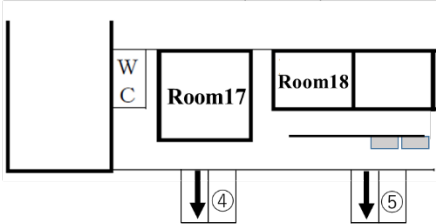

Room27 and 28 (2nd floor)

